



A



ALFRA – Notch pliers

- Easily and quickly punches notches in sheet metals of up to 2.5 mm thickness.
- Saves one from the time-consuming filing of grooves for anti-twist protection of push buttons, switches and instruments.
- Notch sizes in 3.2 mm and 4.8 mm possible.
- Long tool life because punch and die are made out of hardened tool steel.
- Easy punching due to large leverage.
- Handgrips are plastic coated.
- Weight 1.3 kg

The notch puncher is inserted into the pre-punched opening, aligned to the cross-hairs marking and then the pliers is actuated. A clean notch is ready!



Prod.-No. 03015

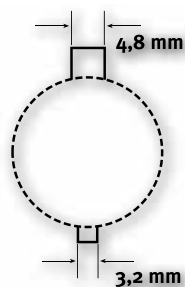

Prod.-No.
03015

ALFRA Notch pliers

Prod.-No.
030151

Spare parts

Notch puncher with rivet pin