

A



ALFRA PUNCHER – Special shapes

Complete for hand and hydraulic operation • Made in Germany by ALFRA

- All punchers have a lateral ejection for the waste piece. No getting stuck inside the die.
- Punchers are delivered in stable plastic boxes.
- When placing an order for hydraulic operation please specify the hydraulic model.

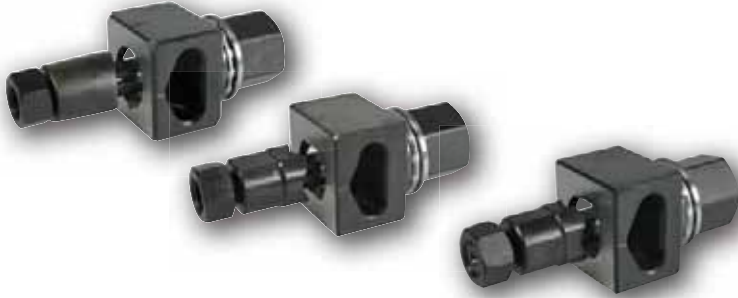

Prod.-No. 01423

Spare parts

Size mm	Max. Material thickness mm/St 37	For operation by	Prod.-No. Puncher complete	Prod.-No. Tie bolt	Prod.-No. Locking nut	Prod.-No. BB pressure nut	Prod.-No. Adapter for hydraulics	Pre-drilling Ø mm
 Ø 22,5 with 3 mm nose	2,0	Hand/hydr.	01420	01333 anti-twist-protection	01351	01352	01353	14
 Ø 22,5 2-side flattened to 18.5 mm	2,0	Hand/hydr.	01421	01347	01351	01352	01353	14
 Ø 22,5 4-side flattened to 20.1 mm	2,0	Hand/hydr.	01422	01347	01351	01352	01353	14
 33,3 x 17,0 x 10,0 for profile cylinder	2,0	Hand/hydr.	01423	01347	01351	01352	01353	14
 Ø 16,3 4-side flattened to 14.1 mm	1,75	Hand/hydr.	01427	01348	01355	01352	01353	11

PUNCHER – special fabrications

Single fabrications are possible!!! • Made in Germany by ALFRA

- We can fabricate all round, square, rectangular punchers according to drawing at short notice.
- Please specify upon inquiry, whether for hand or hydraulic operation and the thickness and material number.
- Tools – punches – dies suitable for novopress e.g. HSTL 880/HTL 400 – are available for SUPPLY!!!
- Ask for our technical advice.

